

ALL DIMENSIONS REFERENCE

26-11XX-XXX

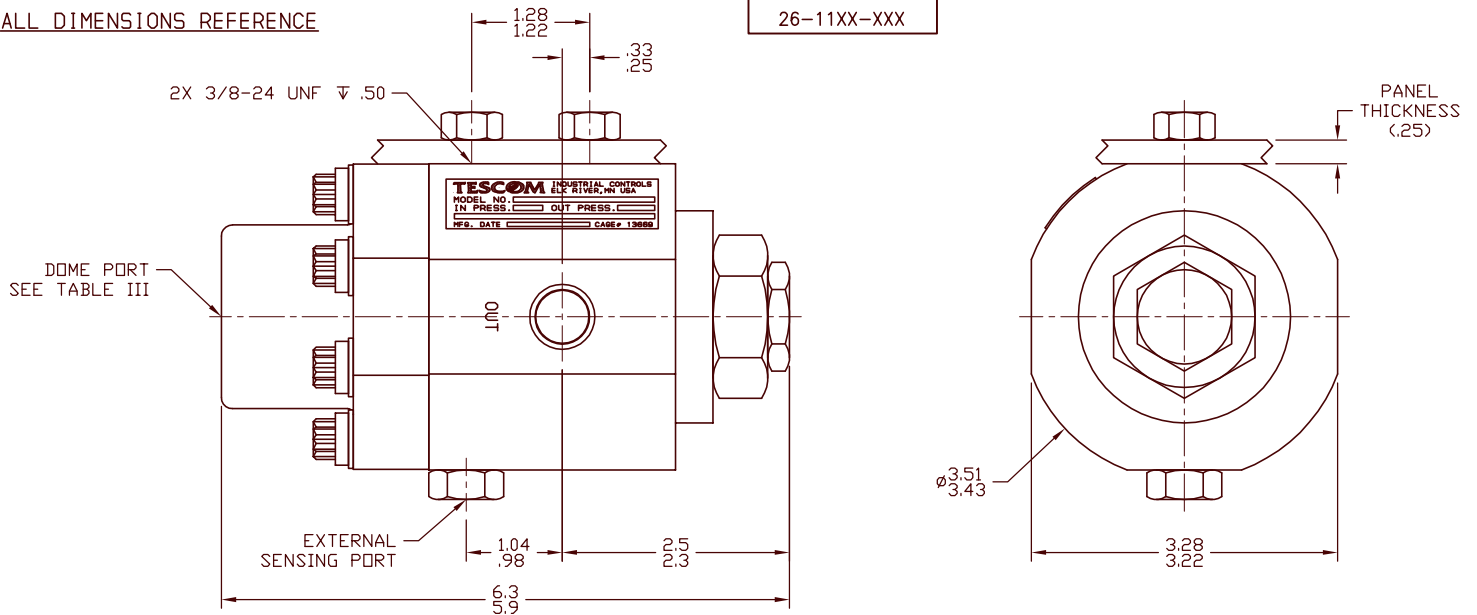

26-1100 SERIES REGULATOR

EXTERNALLY GAS LOADED PRESSURE  
REDUCING REGULATOR NONVENTING

GENERAL SPECIFICATIONS:

INLET PRESSURE:  
SST BODY 10000 PSI MAX  $\phi$ .250 ORIFICE  
SST BODY 6000 PSI MAX  $\phi$ .375 ORIFICE  
ALUMINUM BODY 6000 PSI MAX  
BRASS BODY 6000 PSI MAX

OUTLET PRESSURE: TO MAX INLET

DESIGN PROOF PRESSURE: 150% OF RATED PRESSURE

PRESSURE RATING: PER CRITERIA OF ANSI/ASME B31.3

OPERATING TEMPERATURE: -40°F TO +165°F

LEAKAGE: BUBBLE TIGHT

WEIGHT: APPROX 4 LBS ALUMINUM  
APPROX 10 LBS BRASS & SST

MATERIALS CONTACTING LINE MEDIA:

DIAPHRAGM: BUNA-N  
O-RINGS: BUNA-N  
BACK-UP RINGS: TEFLON  
BODY: SEE TABLE I  
SEAT: CTFE  
GASKET: CTFE  
RETAINING RING: 15-7 SST  
VALVE CAP: 17-4 SST  
REMAINING PARTS: 300 SERIES SST, BRASS,  
OR ALUMINUM

ASSEMBLY INFORMATION:

FOR ASSEMBLY OF THIS UNIT USE SPEC: A60185-01

KITS:

NON-METALLIC: 389-1163 - -  $\phi$ .250 VALVE SIZE  
389-1164 - -  $\phi$ .375 VALVE SIZE

REPAIR: 38-1111-26 - -  $\phi$ .250 VALVE SIZE  
38-1121-26 - -  $\phi$ .375 VALVE SIZE

EXTERNAL SENSING KIT: 389-1022

26-1121-381

SERIES NUMBER

TABLE I	DASH NO.	BODY MATERIAL
	1	BRASS
	2	303 SST
	3	ALUMINUM 2024-T351
	6	316 SST

TABLE V	DASH NO.	INNER VALVE SIZE
	1	$\phi$ .250 ORIFICE
	2	$\phi$ .375 ORIFICE

TABLE IV	DASH NO.	INLET & OUTLET PORT SIZE
	6	3/8
	8	1/2

TABLE III	DASH NO.	IN & OUT PORT TYPE	DOME PORT
	1	SAE	1/4 MS33649
	2	NPT	1/4 NPT
	3	MS33649	1/4 MS33649

TABLE II	DASH NO.	LOADING METHOD
	1	EXTERNALLY LOADED

PANEL CUT-OUT

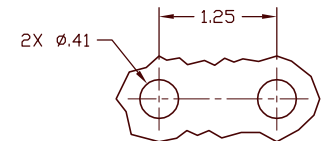

REV.	DATE	ECO NO.	BY:	APPR
AK	8-9-05	1525-05	DLH	TWL
AJ	8-7-03	1500-03	JKK	CRN
AH	9-29-99	2-99	EWN	CRN
AG	12-10-98	1073-98	EWN	CRN
AF	6-4-98	151-98	SJW	TMB
AE	5-18-98	712-98	SJW	CRN
AD	5-5-98	633-98	SKO	CRN
AC	2-19-98	556-98	JLS	MKS

**TESCOM CORPORATION**  
INDUSTRIAL CONTROLS DIVISION  
ELK RIVER, MN USA

INFORMATION CONTAINED ON THIS DOCUMENT IS THE PROPERTY OF TESCOM CORPORATION. NO RIGHTS ARE CONVEYED NOR IS PERMISSION TO DISCLOSE TO OTHERS GIVEN.

UNLESS OTHERWISE SPECIFIED:  
.0  $\pm$  .020 ANGLE:  $\pm$ 1°  
.002  $\pm$  .010  
.000  $\pm$  .005

SURFACE ROUGHNESS: 100/  
CORNER & FILLET RADII: .005-.020  
THREADS: CLASS 2  
REMOVE ALL BURRS  
MFG. SPEC. 80301

DRAWING MADE IN THIRD ANGLE PROJECTION  
(DO NOT SCALE DRAWING)

MATERIAL:		
X		
FINISH:		
X		
DRAWN BY:	CHECKED BY:	APPROVED BY:
JLS 2-19-98	MKS 2-26-98	MKS 2-26-98
NAME		
INSTALLATION INFO		
SCALE: 1 : 1	SIZE	NUMBER
CODE NO. 13669	C	26-11XX-XXX
	SHT.	1 OF 1

NOTES:

- REFER TO SPEC 2110 FOR EXTERNAL SENSING CONNECTION INSTRUCTIONS.