

ALL DIMENSIONS REFERENCE

DVXXXXXXXXXX

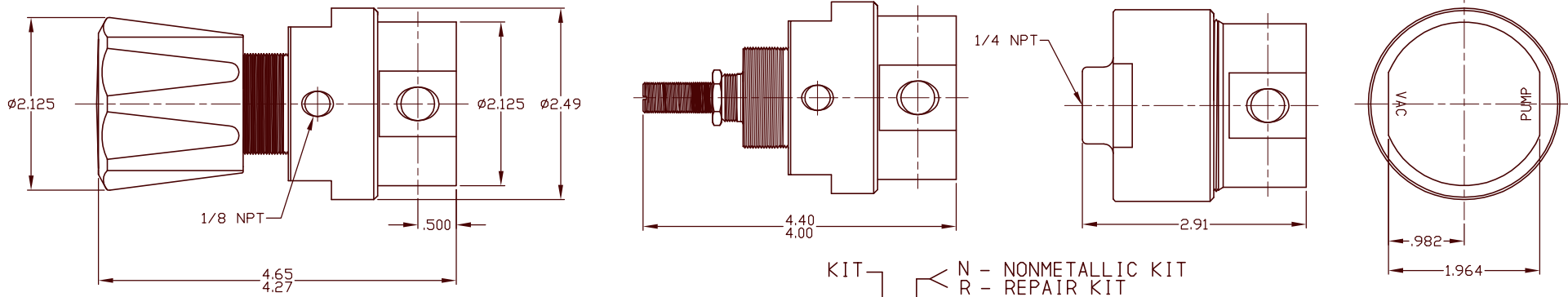

SPRING LOADED. HAND OPERATED
VACUUM BACK PRESSURE REGULATOR

GENERAL SPECIFICATIONS:

CONTROL PRESSURE: SEE TABLE III
 DESIGN PROOF PRESSURE: 150% OF RATED PRESSURE
 PRESSURE RATING, PER CRITERIA OF ANSI/ASME B31.3
 OPERATING TEMPERATURE: -65°F TO +165°F W/BUNA-N
 -60°F TO +250°F W/E.P.
 -15°F TO +400°F W/VITON
 LEAKAGE: INTERNAL; BUBBLE TIGHT
 FLOW CAPACITY (Cv): Cv = .25

MATERIALS CONTACTING LINE MEDIA:

O-RING SEAL: SEE TABLE VI
 BODY: SEE TABLE II
 DIAPHRAGM: SEE TABLE VI
 REMAINING PARTS: 300 SST & BRASS

ASSEMBLY INFORMATION:

FOR ASSEMBLY OF THIS UNIT USE SPEC:

- A60999-01 - HANDKNOB & SCREWDRIVER ADJ.
- A60999-02 - DOME LOADED

NOTES:

- REGULATOR INCORPORATES AN ADJUSTABLE STOP WHICH ALLOWS THE MAXIMUM OUTLET PRESSURE TO BE LIMITED TO ANY VALUE BETWEEN THE MAXIMUM RATED VALUE AND 50% OF THE MAXIMUM RATED VALUE.

FUNCTION / LOAD TYPE	
TABLE I	STANDARD VACUUM NO BLEED
	1 - HANDKNOB ADJUSTING
	2 - SCREWDRIVER ADJUSTING
	3 - CAPT. BONNET/HAND
	4 - CAPT. BONNET/SCREW
5 - DOME LOADED	
TABLE II	STANDARD VACUUM W/CONSTANT BLEED
	A - HANDKNOB ADJUSTING
	B - SCREWDRIVER ADJUSTING
	C - CAPT. BONNET/HAND
D - CAPT. BONNET/SCREW	

BODY MATERIAL	
TABLE II	1 - BRASS
	3 - ALUMINUM

CONTROLLED VACUUM PRESSURE (INCHES Hg)	
TABLE III	5 0-28" Hg (0-71 cm Hg)
	0-25" Hg (0-64 cm Hg) W/ CONSTANT BLEED
	9 -4 PSIG (0 in hg)
	(ONLY USED W/ CONSTANT BLEED)

VALVE PARTS	
TABLE IV	B - BRASS

O-RING & DIAPHRAGM MATERIAL	
TABLE VI	B - BUNA-N
	E - ETHYLENE PROPYLENE
	V - VITON

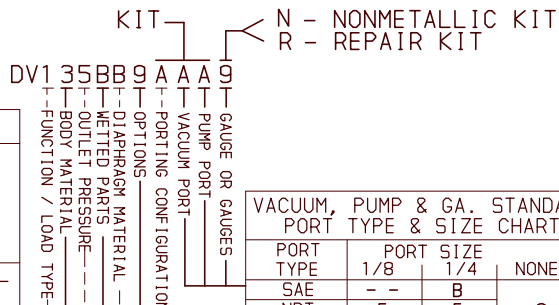

VACUUM, PUMP & GA. STANDARD PORT TYPE & SIZE CHART			
PORT TYPE	PORT SIZE		NONE
	1/8	1/4	
SAE	-	B	9
NPT	E	F	
MS33649	-	J	

STANDARD PORTING CONFIGURATION	
A - NO GAUGE PORTS	
B - GAUGE PORTS @ 60°	
F - OUT GAUGE @ 90°	
G - IN GAUGE @ 90°	
L - GAUGE PORTS @ 90°	

REV.	DATE	ECO NO.	BY	APPR
R	7-28-06	1493-06	DKD	DP
P	2-17-06	114-06	DKD	DP
N	5-21-03	1-03	SKO	MKS
M	3-30-03	1210-03	JLS	MKS
L	9-22-99	1024-99	JLS	MKS

TESCOM CORPORATION
 INDUSTRIAL CONTROLS DIVISION
 BELK RIVER, MN USA

INFORMATION CONTAINED ON THIS DOCUMENT IS THE PROPERTY OF TESCOM CORPORATION. NO RIGHTS ARE CONVEYED NOR IS PERMISSION TO DISCLOSE TO OTHERS GIVEN.

UNLESS OTHERWISE SPECIFIED:
 .0 ± .020 ANGLES: ±1°
 .00 ± .010
 .000 ± .005
 SURFACE ROUGHNESS: 100/
 CORNER & FILLET RADI: .005-.020
 THREADS: CLASS 2
 REMOVE ALL BURRS
 MFG. SPEC. 80301

DRAWING MADE IN THIRD ANGLE PROJECTION
 (DO NOT SCALE DRAWING)

MATERIAL: χ		
FINISH: χ		
DRAWN BY: JLS	CHECKED BY: MKS	APPROVED BY: MKS
9-22-99	6-2-00	6-2-00
NAME: INSTALLATION INFO.		
SCALE: 1:1	SIZE: C	NUMBER: DVXXXXXXXXXX
CODE NO. 13669	SHT. 1	OF 1